

SCALE 1/1

Specification:

Material :

1. Metal Cover : SPCC, 0.5 mm thickness with Nickel plated.
2. IDC :
 - 2-1. Housing : PC, UL 94V-2.
 - 2-2. Terminal : Phosphor Bronze with Tin plated.
3. Cable Holder : Phosphor Bronze 0.5 mm thickness with Nickel plated.
4. Housing : ABS+PC, UL 94V-0.
5. PCB : FR4, UL 94V-0.

Performance :

- a. T568A & T568B wiring Printing on IDC.
- b. Operating temperature : -10°C to 60°C. (ISO/IEC 11801, ANSI/TIA/EIA 568 C.2)
- c. Durability :
 - *IDC : Suitable for 22-26 AWG stranded and solid wire, compatible with both 110 & Krone punch down tool.
- d. The Cat.6 transmission performance is in compliance with the ANSI/TIA/EIA 568 C.2 standard.

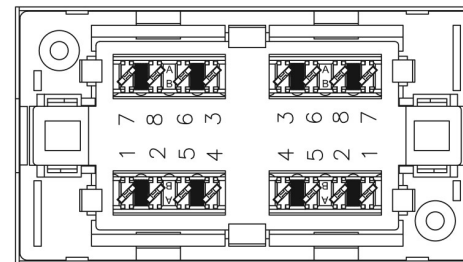
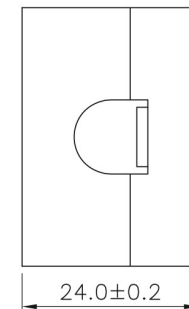
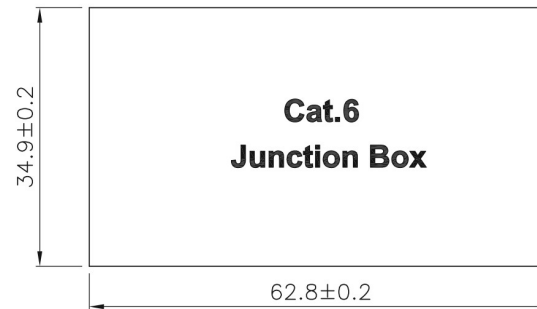
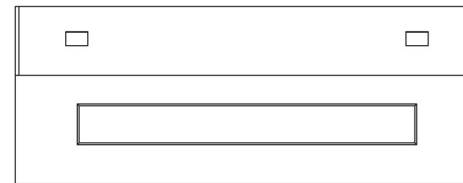

GENERAL TOLERANCE OF DIMENSIONS X.XXX ±0.005 X.XX ±0.05 X.X ±0.1	DRAWING	23.NOV.2016	WESLEY	 SFCable 1-888-275-8755	
	CHECK	23.NOV.2016	DAY		
	APPROVAL	23.NOV.2016	JAIMY	ITEM NO.: CAT6-BX-06-C61-SH	
	SCALE		1/1 (A4)	UNIT	mm
DRAWING NO.		AAGBA0200043115 JE316-KDA-C6FS(SA3)			
DRAWING CLASSIFICATION		S	SHEET		1 OF 1