

Product Name	HDMI Male to Female Adapter--180 degree
Product Numbers	SF-CV308

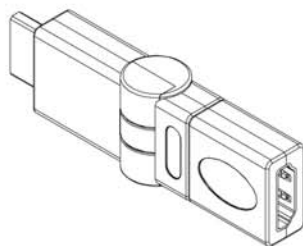

NO.	SUB PART NAME OR NO.	MATERIAL	MANUF ACTURE TYPE & FINISH	QTY	REMARK
1	HDMI AF	PBT	Au /Sn PLATED	1	94ULV-0
2	HDMI AM		Au /Sn PLATED	1	
3	WIRE		Color:BLACK	19	
4	EARTH WIRE		Color:BLACK	1	
5	FORMER COVER UP	ABS	Color:BLACK	1	
6	FORMER COVER DOWN	ABS	Color:BLACK	1	
7	CENTER COVER UP	ABS	Color:BLACK	1	
8	CENTER COVER DOWN	ABS	Color:BLACK	1	
9	BACK COVER UP	ABS	Color:BLACK	1	
10	BACK COVER DOWN	ABS	Color:BLACK	1	

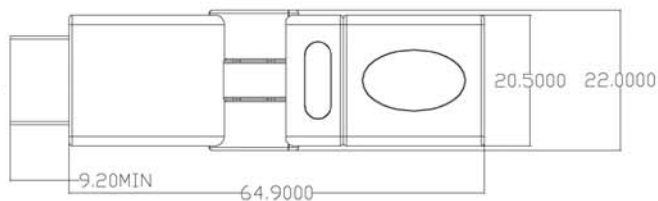
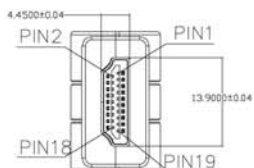
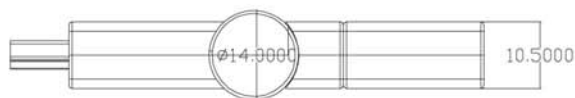
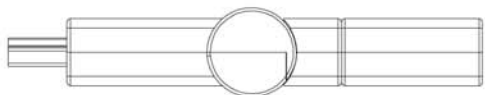
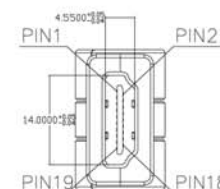
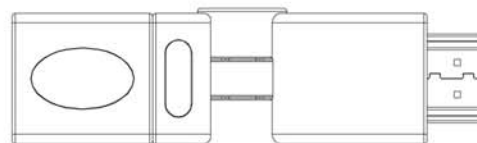

备注:

1. 额定电流 CURRENT RATING: 0.5A MAX.
2. 额定电压 VOLTAGE RATING: 40V AC MAX.
3. 接触阻抗 CONTACT RESISTANCE: 50M OHMS MAX.
4. 耐电压 Withstand voltage: 500V AC MIN.(UNMATED)
300V AC MIN.(MATED)
5. 绝缘电阻 Insulation Resistance: 100MΩ MIN.(UNMATED)
10MΩ MIN.(MATED)
6. 耐久性 INSULATION RESISTANCE: 50000MOHS MIN.
7. 工作温度 OPERATING TEMPERATURE : -25℃ TO +85℃.

Type A-to-Type A Cable & Adaptor Wire Assignment

Type A pin	Signal Name	Wire	Type A pin	10	11	12	13	14	15	16	17	18	19
1	TMDS Data2+	B	1	TMDS Clock+	B	10							
2	TMDS Data2 Shield	A	2	TMDS Clock Shield	A	11							
3	TMDS Data2-	A	3	TMDS Clock-	A	12							
4	TMDS Data1+	B	4	CEC	D	13							
5	TMDS Data1 Shield	A	5	Utility	C	14							
6	TMDS Data1-	A	6	SCL	C	15							
7	TMDS Data0+	B	7	SDA	C	16							
8	TMDS Data1 Shield	A	8	DDC/CEC Ground	C	17							
9	TMDS Data0-	A	9	+5V Power	5V	18							
				Hot Plug Detect	C	19							

REV.	DESCRIPTION			DATE	
①	TOLERANCE INCHES M/M			SFCABLE.COM TITLE: SF-CV308	
.X	.015	.30			
.XX	.010	.10			
.XXX	.005	.05			
DRAWN BY	Dawson			HDMI Male to Female Adapter--180 degree	
CHECK BY		SCALE	NONE	DRAWING NO:	REV. A
APPD BY		UNIT	MM		
		DATE	2013.03.08		1/3